

TEATOWN LAKE DREDGING

PREPARED FOR THE TEATOWN LAKE RESERVATION

TOWN OF OSSINING, WESTCHESTER COUNTY, NEW YORK

TEATOWN LAKE
RESERVATION NATURE PRESERVE



WSP USA INC.
500 Summit Lake Drive, Suite 450
Valhalla, NY 10595
(914) 747-1120

ENGINEER OF RECORD:



NEW YORK STATE LICENSED
PROFESSIONAL ENGINEER

UNAUTHORIZED ALTERATIONS AND ADDITIONS TO THIS
DRAWING IS A VIOLATION OF SECTION 7209 (2)
OF THE NEW YORK STATE EDUCATION LAW

KEY PLAN:

REVISIONS:

PROJECT NAME:

**TEATOWN LAKE DREDGING
PROJECT**

WESTCHESTER COUNTY, NEW YORK

ISSUE DATE:

JUNE 2023

PROJECT NUMBER:

SCALE:

X

NONE

DRAWING NAME:

COVER SHEET

DRAWING NUMBER:

CS101

SHEET NUMBER:

1 OF 9



LOCATION MAP

N.T.S.

THE LATEST REVISIONS OF THE NYSDOT STANDARD SHEETS, WHICH ARE CURRENT ON THE DATE OF ADVERTISEMENT FOR BIDS, SHALL BE CONSIDERED TO BE IN EFFECT. ALL PAY ITEMS AND WORK CONTAINED IN THE CONTRACT AND ANY ADDITIONAL PAY ITEMS AND WORK ENCOUNTERED DURING THE COURSE OF THE CONTRACT SHALL BE SUBJECT TO THE APPLICABLE STANDARD SHEET(S) UNLESS OTHERWISE SPECIFIED IN THE CONTRACT DOCUMENTS.

ALL WORK CONTEMPLATED UNDER THIS CONTRACT IS TO BE COVERED BY AND IN CONFORMITY WITH THE NYSDOT STANDARD SPECIFICATIONS (US CUSTOMARY UNITS) OF MAY 1, 2018, EXCEPT AS MODIFIED ON THESE PLANS AND IN THE ITEMIZED PROPOSAL.

CONTRACT PLANS HAVE BEEN DESIGNED IN ACCORDANCE WITH NYSDOT POLICIES AND GUIDELINES.

IT IS A VIOLATION OF LAW FOR ANY PERSON, UNLESS THEY ARE ACTING UNDER THE DIRECTION OF A LICENSED PROFESSIONAL ENGINEER, ARCHITECT, LANDSCAPE ARCHITECT OR LAND SURVEYOR, TO ALTER AN ITEM IN ANY WAY. IF AN ITEM BEARING THE STAMP OF A LICENSED PROFESSIONAL IS ALTERED, THE ALTERING ENGINEER, ARCHITECT, LANDSCAPE ARCHITECT OR LAND SURVEYOR SHALL STAMP THE DOCUMENT AND INCLUDE THE NOTATION "ALTERED BY" FOLLOWED BY THEIR SIGNATURE, THE DATE OF SUCH ALTERATION, AND A SPECIFIC DESCRIPTION OF THE ALTERATION.

| INDEX OF DRAWINGS | | |
|-------------------|--|---------|
| SHEET NO. | TITLE | DRAWING |
| 1 | COVER SHEET | CS101 |
| 2 | GENERAL NOTES | GEN101 |
| 3 | OVERALL PLAN | GEN102 |
| 4 | LAKE DREDGING PLAN | GEN103 |
| 5 | GEOTUBE STOCKPILE SITE NO. 1 PLAN | SP101 |
| 6 | GEOTUBE STOCKPILE SITE NO. 2 PLAN | SP102 |
| 7 | SITE NO. 1 & 2 SECTIONS (SHEET 1 OF 2) | GR101 |
| 8 | SITE NO. 1 & 2 SECTIONS (SHEET 2 OF 2) | GR102 |
| 9 | EROSION & SEDIMENT CONTROL DETAILS | DET101 |
| 10 | | |

DRAFT - NOT FOR CONSTRUCTION

GENERAL NOTES:

- UNLESS NOTED OTHERWISE, ALL WORK SHALL BE PERFORMED IN ACCORDANCE WITH NEW YORK STATE DEPARTMENT OF TRANSPORTATION, OFFICE OF ENGINEERING STANDARD SPECIFICATIONS - CONSTRUCTION AND MATERIALS DATED SEPTEMBER 1, 2022 AS AMENDED BY CURRENT ADDITIONS AND MODIFICATIONS THERETO, THE 2015 INTERNATIONAL CODES, 2017 UNIFORM CODE SUPPLEMENT, WESTCHESTER COUNTY DEPARTMENT OF HEALTH REGULATIONS AND LOCAL CODES HAVING JURISDICTION OVER THE WORK.
- WHEN PROPOSED WORK SHOWN IN THE PLANS AND SPECIFICATIONS IS IN CONFLICT, THE INFORMATION IN THE SPECIFICATIONS SHALL GOVERN.
- THE CONTRACTOR SHALL EXAMINE AND VERIFY IN THE FIELD ALL EXISTING AND GIVEN CONDITIONS AND DIMENSIONS WITH THOSE SHOWN ON THE CONTRACT DOCUMENTS. IF THE FIELD CONDITIONS AND DIMENSIONS DIFFER FROM THOSE SHOWN ON THE CONTRACT DOCUMENTS, THE CONTRACTOR SHALL NOTIFY THE ENGINEER, ALL FIELD CONDITIONS AND DIMENSIONS SHALL BE SO NOTED ON THE DRAWINGS AND SUBMITTED FOR APPROVAL.
- THE CONTRACTOR'S ATTENTION IS DIRECTED TO THE FACT THAT, DUE TO THE NATURE OF THIS PROJECT, THE EXACT EXTENT OF WORK CAN NOT ALWAYS BE ACCURATELY DETERMINED PRIOR TO THE COMMENCEMENT OF WORK. THE CONTRACT DOCUMENTS HAVE BEEN PREPARED BASED ON FIELD INSPECTION AND OTHER INFORMATION AVAILABLE AT THE TIME. ACTUAL FIELD CONDITIONS MAY REQUIRE MODIFICATIONS TO CONSTRUCTION DETAILS AND WORK QUANTITIES. THE CONTRACTOR SHALL PERFORM THE WORK IN ACCORDANCE WITH THE FIELD CONDITIONS AND A.O.B.E.. ALL FIELD CONDITIONS AND DIMENSIONS DIFFERENT FROM THE DRAWINGS SHALL BE NOTED & SUBMITTED TO THE ENGINEER FOR APPROVAL.
- ALL BIDDERS SHOULD INSPECT THE PROJECT SITE PRIOR TO SUBMITTING BIDS TO VERIFY THE FIELD CONDITIONS WHICH MAY BE ENCOUNTERED AND THE NATURE OF THE WORK TO BE DONE UNDER THIS CONTRACT. NO COMPENSATION WILL BE ALLOWED TO THE BIDDER FOR FAILURE TO INCLUDE ALL LABOR, MATERIALS AND EQUIPMENT COSTS NECESSARY TO COMPLETE THE WORK.
- CONCURRENT WITH CONSTRUCTION WORK OF THIS CONTRACT, OTHER PROJECTS ON THIS SITE AND ADJACENT AREAS MAY BE UNDER CONSTRUCTION. THE CONTRACTOR SHALL COORDINATE HIS/HER WORK THROUGH THE ENGINEER ON ALL ONGOING CONSTRUCTION PROJECTS.
- THE CONTRACTOR SHALL PERFORM ALL WORK WITH CARE SO THAT ANY MATERIALS WHICH ARE TO REMAIN IN-PLACE OR WHICH ARE TO REMAIN IN THE PROPERTY OF THE OWNER WILL NOT BE DAMAGED. IF THE CONTRACTOR DAMAGES ANY MATERIALS WHICH ARE TO REMAIN THE PROPERTY OF THE OWNER, THE DAMAGED MATERIALS SHALL BE REPAIRED OR REPLACED IN A MANNER SATISFACTORY TO THE ENGINEER AT THE EXPENSE OF THE CONTRACTOR.
- THE CONTRACTOR SHALL BE RESPONSIBLE FOR CHECKING EXISTING GRADES, ROADWAYS AND UTILITIES WHICH MAY AFFECT THE WORK.
- THE CONTRACTOR SHALL ESTABLISH OR VERIFY DIMENSIONS OF EXISTING STRUCTURES, EQUIPMENT AND THEIR LOCATIONS WITH THE REQUIRED ACCURACY WHERE NEEDED.
- THE CONTRACTOR SHALL FOLLOW OSHA SAFETY AND HEALTH STANDARDS (29 CFR 1925/1910, LATEST REVISION) AS WELL AS ALL STATE AND LOCAL REQUIREMENTS.
- UTILITIES SHALL BE PROTECTED AND MAINTAINED AT ALL TIMES. CONTRACTOR SHALL DETERMINE THE EXACT LOCATION OF ALL UTILITIES AND SHALL "MARK OUT" EACH UTILITY PRIOR TO PROCEEDING WITH ANY EXCAVATION OR SITE WORK. CONTRACTOR IS RESPONSIBLE FOR NOTIFICATION TO ALL UTILITIES BY MEANS OF CODE 753. CERTAIN UTILITIES SUCH AS TRAFFIC LOOP DETECTORS ARE NOT COVERED UNDER THE CODE 753 CALL OUT. CONTRACTOR IS RESPONSIBLE FOR COORDINATING WITH UTILITY OWNERS FOR THEIR MARK OUT AND TO MAKE ARRANGEMENTS PRIOR TO THE START OF WORK. CONTRACTOR SHALL BE HELD RESPONSIBLE FOR RESTORATION AND REPAIR OF ANY DAMAGE AT NO ADDITIONAL COST TO THE OWNER.
- THE CONTRACTOR SHALL BE RESPONSIBLE FOR THE PROTECTION OF HIS WORK AND NEWLY INSTALLED OR EXISTING WORK, INCLUDING PROTECTION OF PARK OCCUPANTS, PUBLIC AND PERSONNEL. CONTRACTOR SHALL PROVIDE APPROPRIATE BARRIERS AND SAFETY MEASURES AS REQUIRED.
- SUBMISSION OF CONTRACTOR'S BID IMPLIES THAT HE HAS EXAMINED THE EXISTING FACILITIES BY MEANS OF SITE INSPECTION AND OTHER MEANS, AND IS FAMILIAR WITH ALL THE REQUIREMENTS OF THE WORK. ADDITIONAL COMPENSATION REQUESTS WILL NOT BE CONSIDERED DUE TO THE CONTRACTORS FAILURE TO INFORM HIMSELF OF THE SITE CONDITIONS AND CONTRACT REQUIREMENTS.
- THE CONTRACTOR SHALL PROVIDE ALL CUTTING AND PATCHING AS REQUIRED FOR THE INSTALLATION OF HIS WORK, COST INCLUDED UNDER THE APPROPRIATE PAY ITEM.
- ALL CONSTRUCTION WORK SHALL BE CONFINED TO THE AREA INDICATED ON THE PLANS AND SHALL NOT BLOCK MEANS OF EGRESS.
- ANY IMPORTED TOPSOIL SHALL COMPLY WITH ALL FEDERAL, STATE, AND LOCAL REQUIREMENTS FOR QUALITY AND USE.

ACCESS NOTES:

- CONTRACTOR SHALL MAINTAIN ACCESS ALONG BLINN ROAD AT ALL TIMES BY WAY OF ROADWAY PLATING OR OTHER METHOD APPROVED BY ENGINEER.

UTILITY NOTES:

- THE CONTRACTOR IS ALERTED TO THE RULES AND REGULATIONS OF GENERAL BUSINESS LAW ARTICLE 36 AND PUBLIC SERVICE LAW 119-b (NEW YORK STATE INDUSTRIAL CODE 53 OF TITLE 16, (16 NYCRR PART 753) AND IS DIRECTED TO COMPLY. AT LEAST 2 DAYS BUT NOT MORE THAN 10 WORKING DAYS BEFORE THE COMMENCEMENT DATE OF THE EXCAVATION OR DEMOLITION THE CONTRACTOR SHALL NOTIFY THE NEW YORK CITY ONE-CALL CENTER AT 1-800-272-4480 AND PROVIDE THE LOCATION AND DATE OF THE PROPOSED EXCAVATION OR DEMOLITION.
- LOCATIONS OF EXISTING UTILITIES SHOWN ON THE PLANS HAVE BEEN TAKEN FROM RECORD DRAWINGS AND ARE BASED UPON THE BEST AVAILABLE INFORMATION. ACTUAL FIELD CONDITIONS MAY VARY FROM THE CONDITIONS SHOWN ON THE PLANS AND OTHER INFRASTRUCTURE NOT SHOWN MAY EXIST NEAR OR WITHIN THE AREA OF WORK. IT IS THE CONTRACTOR'S RESPONSIBILITY TO DETERMINE THE EXACT LOCATIONS OF ALL UTILITIES PRIOR TO WORKING IN THE AREA AND TO AVOID INTERFERENCE.
- THE CONTRACTOR SHALL NOTIFY THE ENGINEER IF ANY INFRASTRUCTURE IS EXPOSED AND/OR UNDERMINED DURING THE COURSE OF CONSTRUCTION. IN THE EVENT THE CONTRACTOR DAMAGES AN EXISTING UTILITY SERVICE CAUSING AN INTERRUPTION IN SERVICE, THE CONTRACTOR WILL IMMEDIATELY NOTIFY THE ENGINEER, AND THE UTILITY COMPANY. THE CONTRACTOR SHALL COMMENCE WORK TO RESTORE SERVICE AND MAY NOT CEASE HIS WORK OPERATION UNTIL SERVICE IS RESTORED AT NO ADDITIONAL COST TO THE OWNER.

CULVERT INSTALLATION NOTES

- HDPE CULVERT TO BE LEFT IN PLACE AT THE COMPLETION OF THE PROJECT FOR USE AS A WILDLIFE CROSSING.
- PROPER BEDDING AND BACKFILL TO BE PLACED IN CONFORMANCE WITH PIPE MANUFACTURER REQUIREMENTS
- EXISTING PAVEMENT TO BE SAWCUT (MINIMUM TRENCH WIDTH = 48"), REMOVED AND DISPOSED OF.
- NEW PAVEMENT SECTION TO BE PLACED BACK SHALL MATCH EXISTING TYPE AND THICKNESS OF PAVEMENT LAYERS.
- CULVERT WORK TO BE STAGED SO AS NOT TO IMPEDE THE FLOW OF TRAFFIC. PROPER PERMITS ARE REQUIRED PRIOR TO WORK IN THE ROADWAY.

SOIL EROSION AND SEDIMENT CONTROL NOTES

- ALL SOIL EROSION AND SEDIMENT CONTROL PRACTICES SHALL BE INSTALLED IN ACCORDANCE WITH NEW YORK STANDARDS & SPECIFICATIONS FOR EROSION AND SEDIMENT CONTROL (NEW YORK STATE DEPARTMENT OF ENVIRONMENTAL CONSERVATION (NYSDEC), NOVEMBER 2016), OR MOST CURRENT EDITION.
- ALL EROSION AND SEDIMENT CONTROL MEASURES SHALL BE MAINTAINED UNTIL COMPLETION OF CONSTRUCTION AND SHALL BE IN ACCORDANCE WITH NYSDEC REQUIREMENTS.
- THE LOCAL MUNICIPALITY, NYSDEC OR THE ENGINEER MAY REQUEST ADDITIONAL MEASURES TO MINIMIZE THE POTENTIAL FOR ONSITE OR OFFSITE EROSION PROBLEMS THAT MAY OCCUR DURING CONSTRUCTION. THE CONTRACTOR IS RESPONSIBLE FOR COMPLYING WITH THESE MEASURES.
- NO DISTURBED AREA SHALL BE LEFT EXPOSED FOR MORE THAN 14 DAYS AFTER WORK STOPPAGE. THESE AREAS MUST IMMEDIATELY RECEIVE TEMPORARY SEED AND MULCH. IF THE SEASON PREVENTS THE ESTABLISHMENT OF A TEMPORARY COVER, THE DISTURBED AREAS WILL BE MULCHED WITH STRAW, OR EQUIVALENT MATERIAL. THE SEEDING WILL BE DONE IN ACCORDANCE WITH NEW YORK STATE STANDARDS AND SPECIFICATIONS FOR EROSION AND SEDIMENT CONTROL.
- ANY GRADED AREAS NOT SUBJECT TO FURTHER DISTURBANCE OR CONSTRUCTION TRAFFIC SHALL, WITHIN 10 DAYS OF FINAL GRADING, RECEIVE PERMANENT VEGETATIVE COVER (SEED MIX) IN COMBINATION WITH SUITABLE MULCH AS PER THE NYSDEC, AUGUST 2005 OR LATEST EDITION.
- PAVED AREAS SHALL BE KEPT CLEAN AT ALL TIMES.
- IF FOR ANY REASON THE CONSTRUCTION IS HALTED FOR EXTENDED PERIODS, THE CONTRACTOR SHALL STABILIZE THE SELECT MATERIAL BY HYDRO-SEED OR OTHER MEANS, TO THE SATISFACTION OF THE ENGINEER FOR ALL AREAS DEVOID OF VEGETATION.
- DUST CONTROL - WATER SHALL BE APPLIED BY SPRINKLER OR WATER TRUCK DURING CONSTRUCTION ACTIVITIES TO MINIMIZE SEDIMENT TRANSPORT AND MAINTAIN ACCEPTABLE AIR QUALITY CONDITIONS. REPETITIVE TREATMENTS SHALL BE DONE AS NEEDED TO THE SATISFACTION OF THE ENGINEER.
- THE TIMELY MAINTENANCE OF SEDIMENT CONTROL STRUCTURES IS THE RESPONSIBILITY OF THE CONTRACTOR. ALL STRUCTURES SHALL BE MAINTAINED IN GOOD WORKING ORDER AT ALL TIMES. THE SEDIMENT LEVEL IN ALL SEDIMENT TRAPS SHALL BE CLOSELY MONITORED AND SEDIMENT REMOVED PROMPTLY WHEN MAXIMUM LEVELS ARE REACHED OR AS ORDERED BY THE ENGINEER. ALL SEDIMENT CONTROL STRUCTURES SHALL BE INSPECTED WEEKLY, AND AFTER EACH RAINFALL IN EXCESS OF 1/2 INCH TO INSURE PROPER OPERATION AS DESIGNED.

- THE CONTRACTOR SHALL REPAIR OR REPLACE DAMAGED EROSION CONTROL DEVICES IMMEDIATELY, AND IN NO CASE, MORE THAN TWENTY FOUR (24) HOURS AFTER OBSERVING OR BEING INFORMED ABOUT SUCH DEFICIENCIES.
- THE CONTRACTOR SHALL BE PREPARED TO IMPLEMENT INTERIM DRAINAGE CONTROLS AND EROSION CONTROL MEASURES AS THE NEED ARISES DURING THE COURSE OF CONSTRUCTION.
- THE CONTRACTOR SHALL MAKE AVAILABLE ONSITE ALL EQUIPMENT, MATERIALS AND LABOR NECESSARY TO PERFORM EMERGENCY EROSION CONTROL AND DRAINAGE IMPROVEMENTS WITHIN FOUR (4) HOURS OF ANY IMPENDING EMERGENCY SITUATION.
- ALL SOIL EROSION AND SEDIMENT CONTROL MEASURES SHALL BE MAINTAINED BY THE CONTRACTOR UNTIL FINAL ACCEPTANCE OF THE SITE WORK BY THE OWNER. UPON CERTIFICATION OF FINAL ACCEPTANCE, THE OWNER WILL ASSUME RESPONSIBILITY FOR THE CONTINUED MAINTENANCE OF PERMANENT SOIL EROSION AND SEDIMENT CONTROL MEASURES.
- NO CONSTRUCTION ACTIVITIES OF ANY KIND SHOULD OCCUR WITHIN THE LIMITS OF ANY PROTECTED AREAS INCLUDING, BUT NOT LIMITED TO GRADING, EXCAVATION, STOCKPILING OF MATERIALS, STORAGE OF CONSTRUCTION EQUIPMENT, VEHICLE PARKING, MOVEMENT OF WORKERS OR MACHINERY, OR DUMPING OF CONSTRUCTION DEBRIS.
- ANY IMPORTED TOPSOIL SHALL COMPLY WITH ALL FEDERAL, STATE, AND LOCAL REQUIREMENTS FOR QUALITY AND USE.
- ALL SOIL RESTORATION PROCEDURES SHALL BE CONSISTENT WITH CHAPTER 5 OF THE NYSDEC STORMWATER MANAGEMENT DESIGN MANUAL (JANUARY 2015).
- TEMPORARY SOIL EROSION AND SEDIMENT CONTROLS ARE NOT TO BE REMOVED UNTIL PERMANENT STABILIZATION (80% UNIFORM DENSITY OF PERMANENT VEGETATION OR PERMANENT MULCH/STONE) IS ESTABLISHED IN ALL CONTRIBUTORY DRAINAGE AREAS PER THE NOVEMBER 2016 NYS STANDARDS AND SPECIFICATIONS FOR EROSION AND SEDIMENT CONTROL.
- TEMPORARY SEED SHALL BE PLACED IN ALL DISTURBED AREAS THAT WILL BE LEFT EXPOSED FOR MORE THAN 21 DAYS AND NOT SUBJECT TO CONSTRUCTION TRAFFIC. DISTURBED AREAS SHALL BE LIMITED AND BE COVERED WITH A LAYER OF TOPSOIL PRIOR TO SEEDING. SEEDING SHALL BE INSPECTED FOR BARE SPOTS, WASH OUTS, AND HEALTHY GROWTH. IF REQUIRED, ADDITIONAL SEEDING SHALL BE PERFORMED. THE SEED MIX SHALL FOLLOW THAT SPECIFIED IN THE NYS STANDARDS AND SPECIFICATIONS FOR EROSION AND SEDIMENT CONTROL.

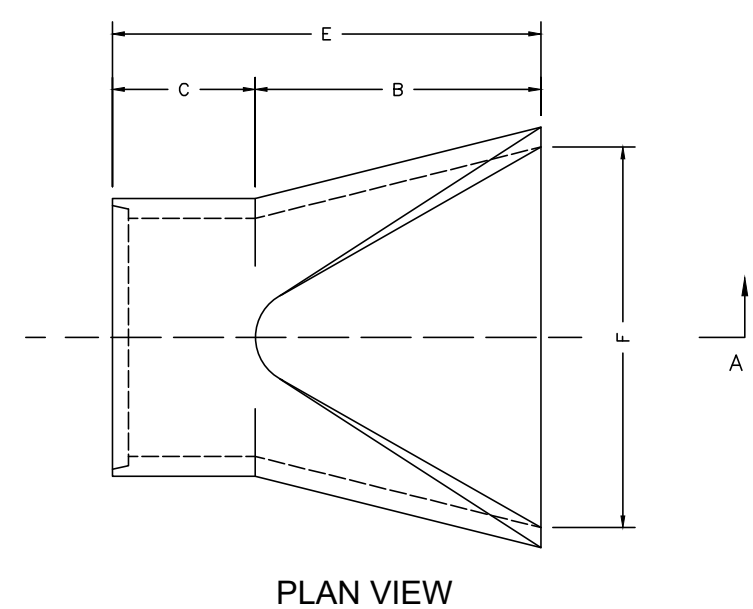

FLARED END SECTION FOR ELLIPTICAL PIPE

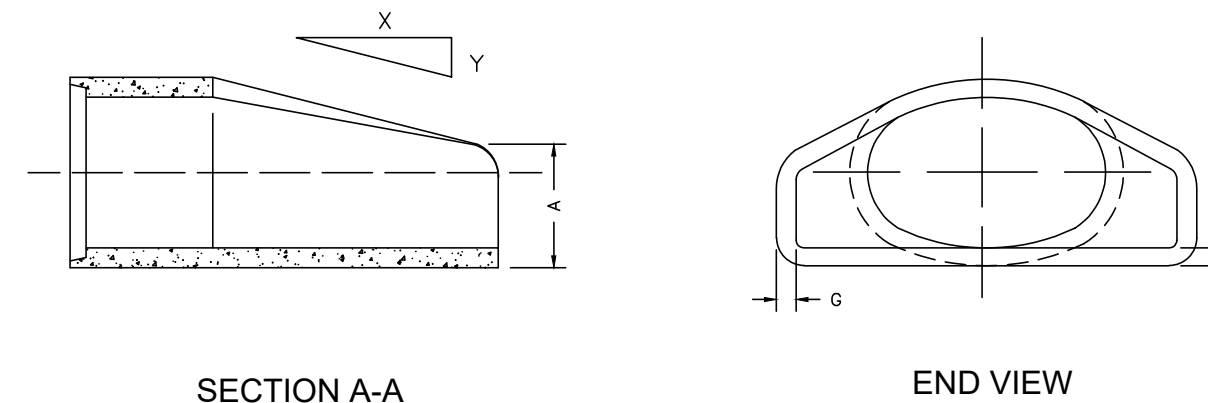

| Diam. | Slope X : Y | Slope | | | | | |
|-------|----------------|-------|-------|-------|-------|-------|--------|
| | | A | B | C | E | F | G |
| 24" | 3 : 1 | 9" | 3'-3" | 2'-9" | 6'-0" | 4'-0" | 3 1/4" |
| 30" | 3 : 1 | 11" | 4'-6" | 1'-6" | 6'-0" | 5'-0" | 3 3/4" |
| 36" | 3 : 1 | 12" | 5'-0" | 3'-0" | 8'-0" | 6'-0" | 4 1/2" |
| 42" | 3 : 1 | 16" | 5'-0" | 3'-0" | 8'-0" | 6'-6" | 5" |
| 48" | 3 : 1 | 21" | 5'-0" | 3'-0" | 8'-0" | 7'-0" | 5 1/2" |
| 54" | 2.4 : 1 | 26" | 5'-0" | 3'-0" | 8'-0" | 7'-6" | 6" |
| 60" | 2 : 1 | 31" | 5'-0" | 3'-0" | 8'-0" | 8'-0" | 6 1/2" |

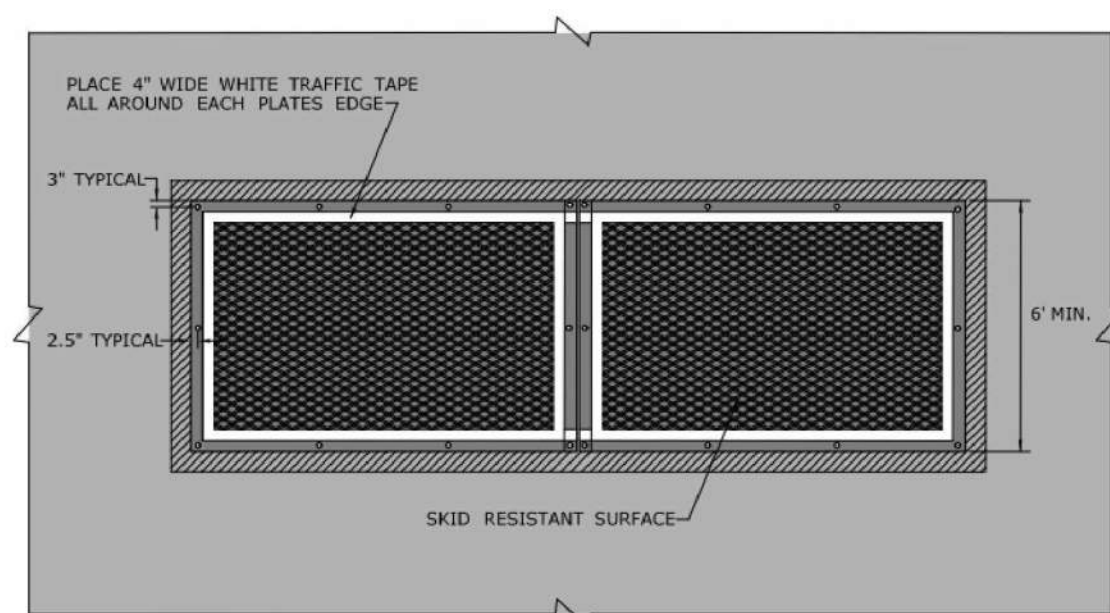

TEMPORARY STEEL PLATES BUTTED TOGETHER

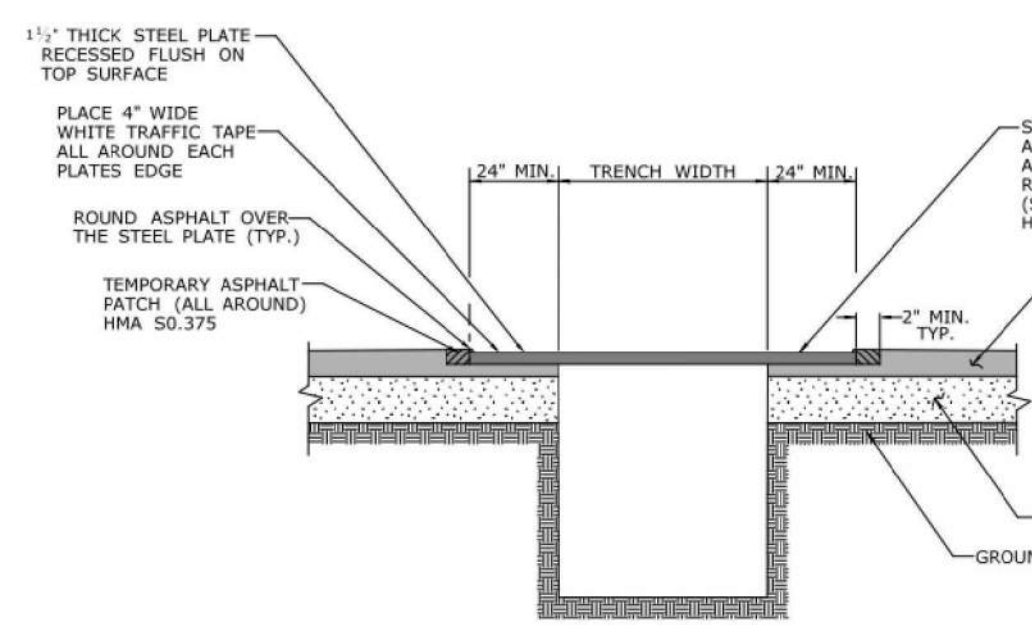

RECESSED TEMPORARY STEEL PLATE OVER TRENCH

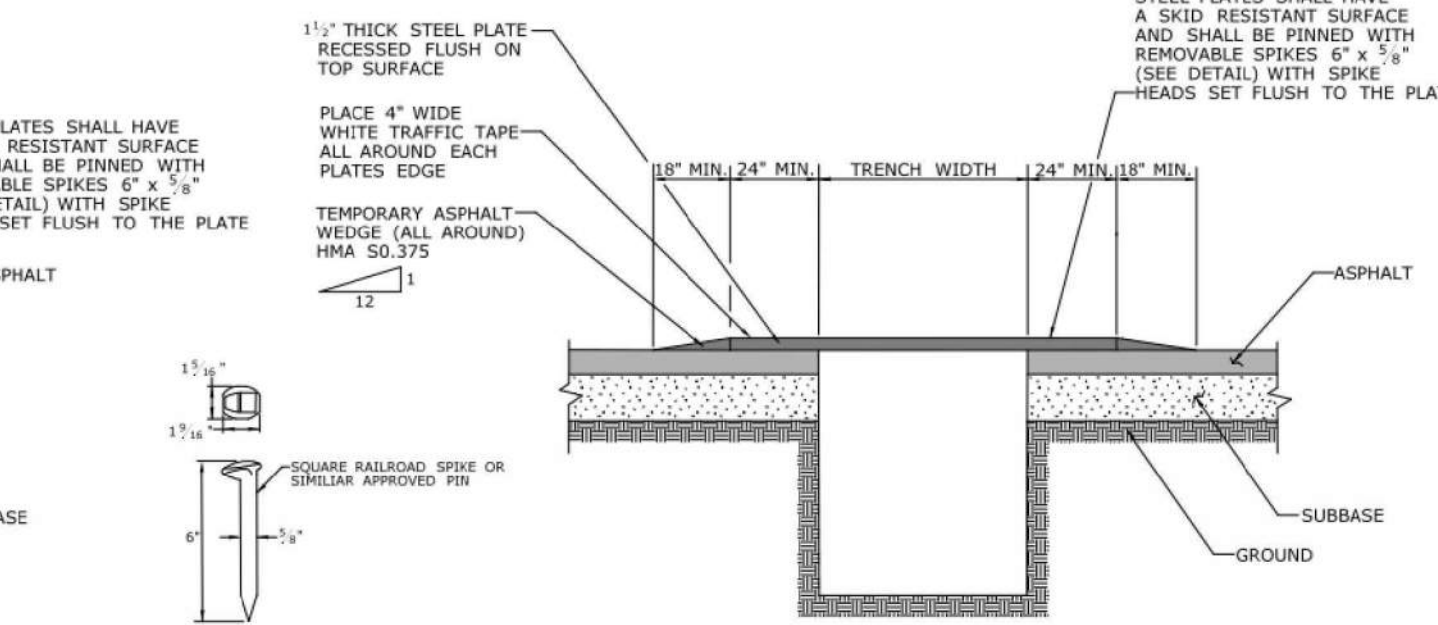

RAMPED TEMPORARY STEEL PLATE OVER TRENCH

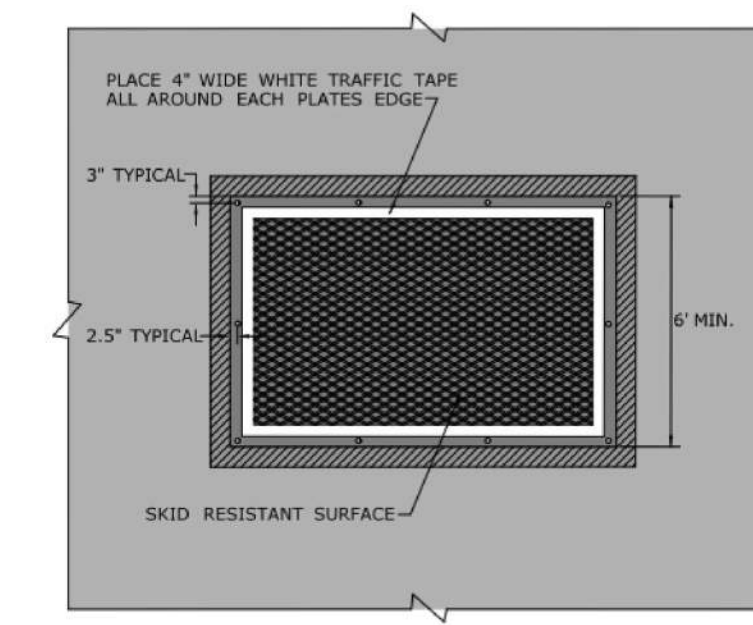

TEMPORARY STEEL PLATE



WSP USA INC.
500 Summit Lake Drive, Suite 450
Valhalla, NY 10595
(914) 747-1120

ENGINEER OF RECORD:



UNAUTHORIZED ALTERATIONS AND ADDITIONS TO THIS
DRAWING IS A VIOLATION OF SECTION 7209 (2)
OF THE NEW YORK STATE EDUCATION LAW

KEY PLAN:

REVISIONS:

PROJECT NAME:

**TEATOWN LAKE DREDGING
PROJECT**

WESTCHESTER COUNTY, NEW YORK

ISSUE DATE:

JUNE 2023

PROJECT NUMBER:

SCALE:

X

NONE

DRAWING NAME:

GENERAL NOTES

DRAWING NUMBER:

GEN101

SHEET NUMBER:

2 OF 9

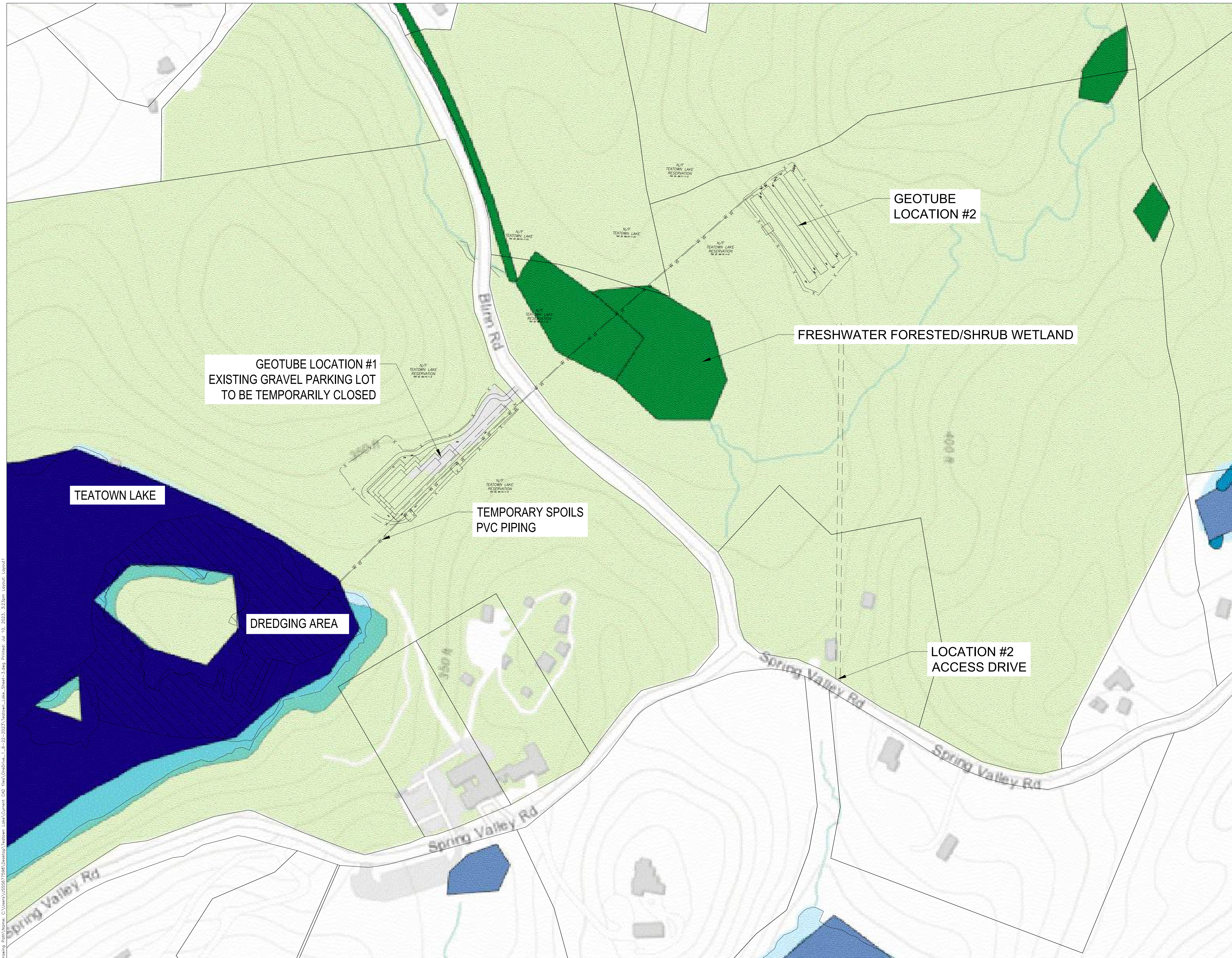

WSP USA INC.
500 Summit Lake Drive, Suite 450
Valhalla, NY 10595
(914) 747-1120

ENGINEER OF RECORD:



NEW YORK STATE LICENSED
PROFESSIONAL ENGINEER

UNAUTHORIZED ALTERATIONS AND ADDITIONS TO THIS
DRAWING IS A VIOLATION OF SECTION 7209 (2)
OF THE NEW YORK STATE EDUCATION LAW

KEY PLAN:



REVISIONS:

| NO. | DESCRIPTION |
|-----|-------------|
| | |
| | |
| | |
| | |

PROJECT NAME:

**TEATOWN LAKE DREDGING
PROJECT**

WESTCHESTER COUNTY, NEW YORK

ISSUE DATE:

JUNE 2023

PROJECT NUMBER:

SCALE:

X

DRAWING NAME:

OVERALL PLAN

DRAWING NUMBER:

GEN102

SHEET NUMBER:

3 OF 9

Drawing Path Name: C:\Users\US5857798\Desktop\Teatown Lake\Current CAD files\06062023\Teatown Lake.dwg Printed: Jul 10, 2023, 5:13pm Layout: Layout1

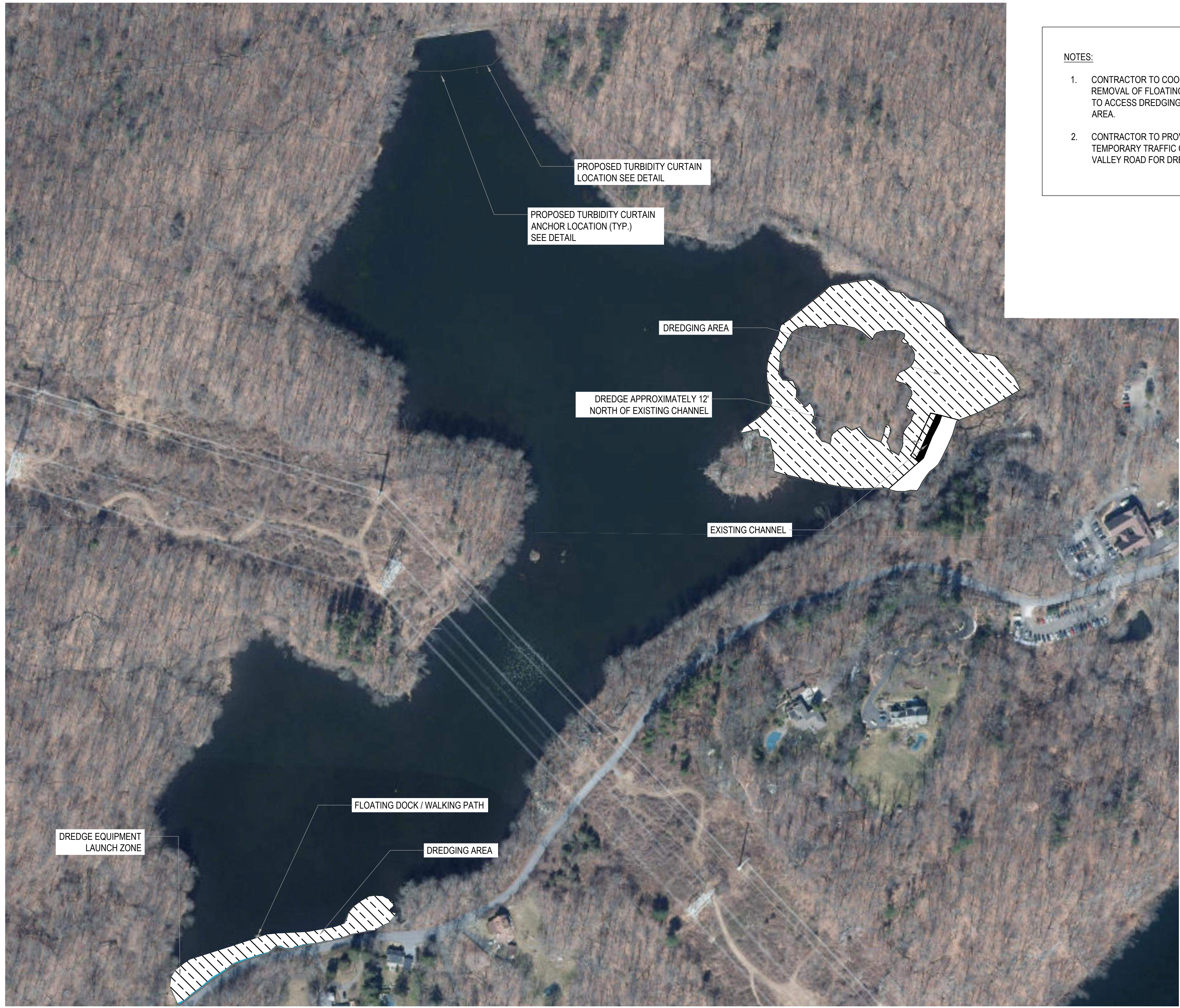

- NOTES:**
1. CONTRACTOR TO COORDINATE THE TEMPORARY REMOVAL OF FLOATING DOCK/ WALKING PATH TO ACCESS DREDGING LOCATION FROM LAUNCH AREA.
 2. CONTRACTOR TO PROVIDE ANY NECESSARY TEMPORARY TRAFFIC CONTROL WITHIN SPRING VALLEY ROAD FOR DREDGE LAUNCH.

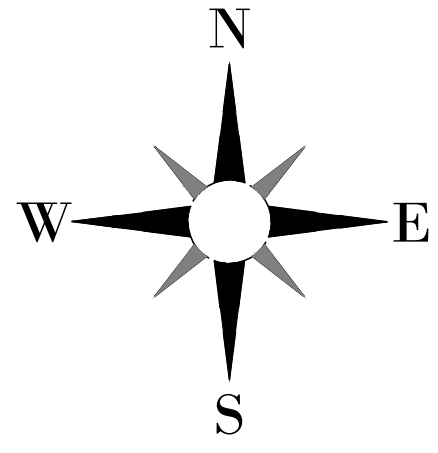

TEATOWN LAKE RESERVATION NATURE PRESERVE



WSP USA INC.
500 Summit Lake Drive, Suite 450
Valhalla, NY 10595
(914) 747-1120

ENGINEER OF RECORD:



NEW YORK STATE LICENSED PROFESSIONAL ENGINEER

UNAUTHORIZED ALTERATIONS AND ADDITIONS TO THIS DRAWING IS A VIOLATION OF SECTION 7209 (2) OF THE NEW YORK STATE EDUCATION LAW

KEY PLAN:

REVISIONS:

PROJECT NAME:

TEATOWN LAKE DREDGING PROJECT

WESTCHESTER COUNTY, NEW YORK

ISSUE DATE:

JUNE 2023

PROJECT NUMBER:

SCALE:

X

DRAWING NAME:

LAKE DREDGING PLAN

DRAWING NUMBER:

GEN103

SHEET NUMBER:

4 OF 9



WSP USA INC.
500 Summit Lake Drive, Suite 450
Valhalla, NY 10595
(914) 747-1120

ENGINEER OF RECORD:



NEW YORK STATE LICENSED
PROFESSIONAL ENGINEER

UNAUTHORIZED ALTERATIONS AND ADDITIONS TO THIS
DRAWING IS A VIOLATION OF SECTION 7209 (2)
OF THE NEW YORK STATE EDUCATION LAW

KEY PLAN:

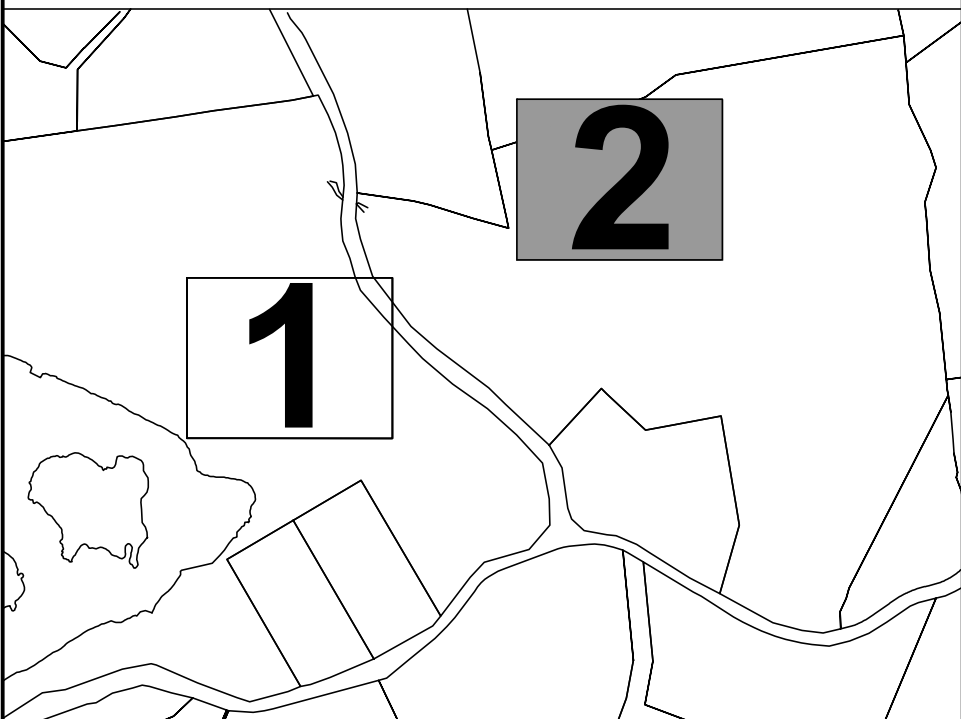

REVISIONS:

| |
|--|
| |
| |
| |
| |
| |

PROJECT NAME:

**TEATOWN LAKE DREDGING
PROJECT**

WESTCHESTER COUNTY, NEW YORK

ISSUE DATE:

JUNE 2023

PROJECT NUMBER:

SCALE:

X

DRAWING NAME:

**GEOTUBE STOCKPILE
SITE NO. 2 PLAN**

DRAWING NUMBER:

SP102

SHEET NUMBER:

6 OF 9

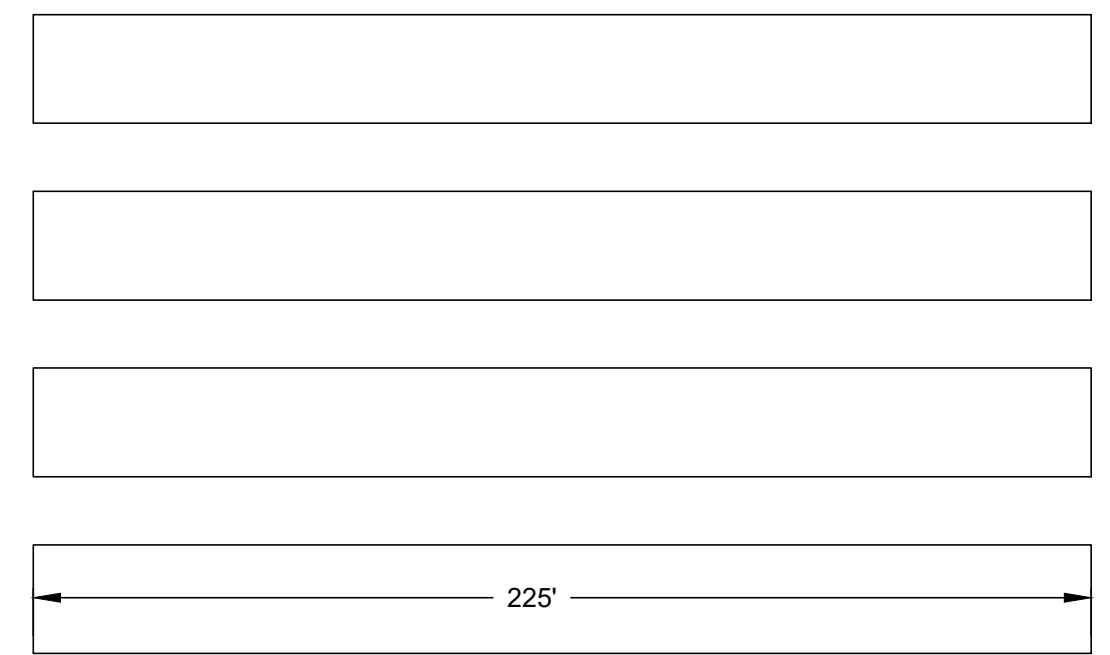
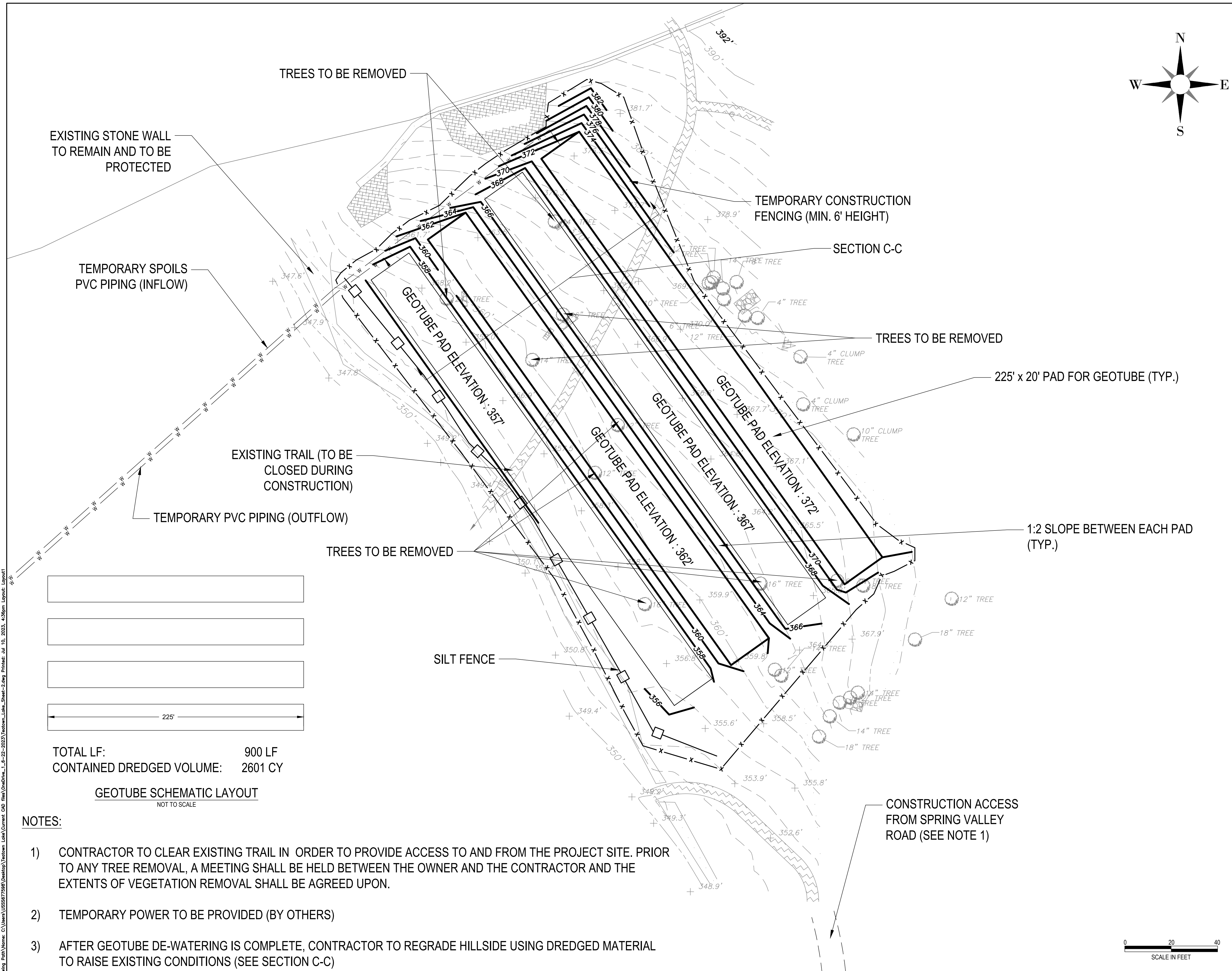
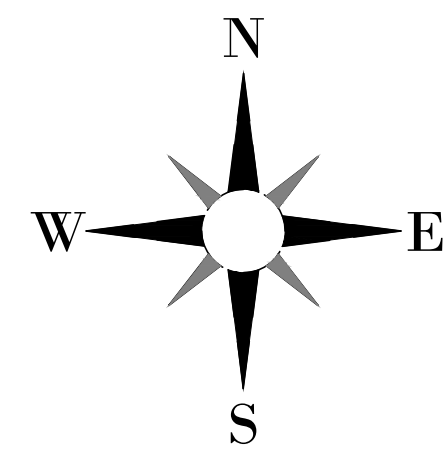

TOTAL LF: 900 LF
CONTAINED DREDGED VOLUME: 2601 CY

GEOTUBE SCHEMATIC LAYOUT
NOT TO SCALE

NOTES:

- 1) CONTRACTOR TO CLEAR EXISTING TRAIL IN ORDER TO PROVIDE ACCESS TO AND FROM THE PROJECT SITE. PRIOR TO ANY TREE REMOVAL, A MEETING SHALL BE HELD BETWEEN THE OWNER AND THE CONTRACTOR AND THE EXTENTS OF VEGETATION REMOVAL SHALL BE AGREED UPON.
- 2) TEMPORARY POWER TO BE PROVIDED (BY OTHERS)
- 3) AFTER GEOTUBE DE-WATERING IS COMPLETE, CONTRACTOR TO REGRADE HILLSIDE USING DREDGED MATERIAL TO RAISE EXISTING CONDITIONS (SEE SECTION C-C)



Drawing Path Name: C:\Users\US85877988\Desktop\Teatown Lake\Current CAD Files\06062023\Teatown_Lake_Sheet-2.dwg Printed: Jul 10, 2023, 4:35pm Layout: Layout1



WSP USA INC.
500 Summit Lake Drive, Suite 450
Valhalla, NY 10595
(914) 747-1120

ENGINEER OF RECORD:



NEW YORK STATE LICENSED
PROFESSIONAL ENGINEER
UNAUTHORIZED ALTERATIONS AND ADDITIONS TO THIS
DRAWING IS A VIOLATION OF SECTION 7209 (2)
OF THE NEW YORK STATE EDUCATION LAW

KEY PLAN:

REVISIONS:

PROJECT NAME:
**TEATOWN LAKE DREDGING
PROJECT**
WESTCHESTER COUNTY, NEW YORK

ISSUE DATE:
JUNE 2023

PROJECT NUMBER: X SCALE:

DRAWING NAME:
**SITE NO. 1 & 2 SECTIONS
(SHEET 1 OF 2)**

DRAWING NUMBER: GR101 SHEET NUMBER:
7 OF 9

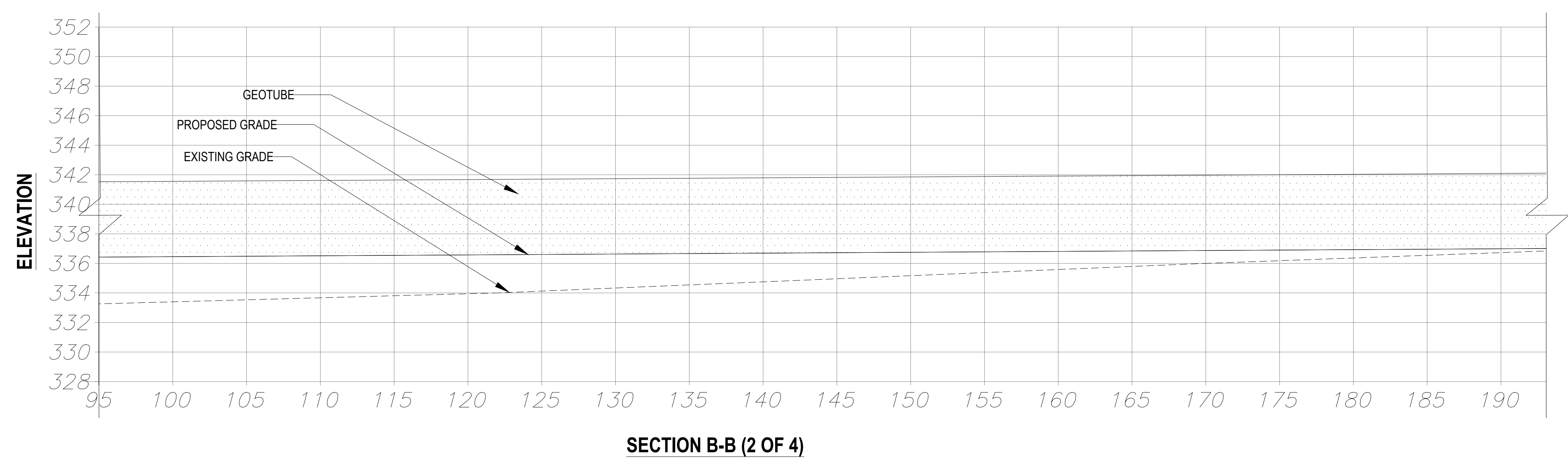
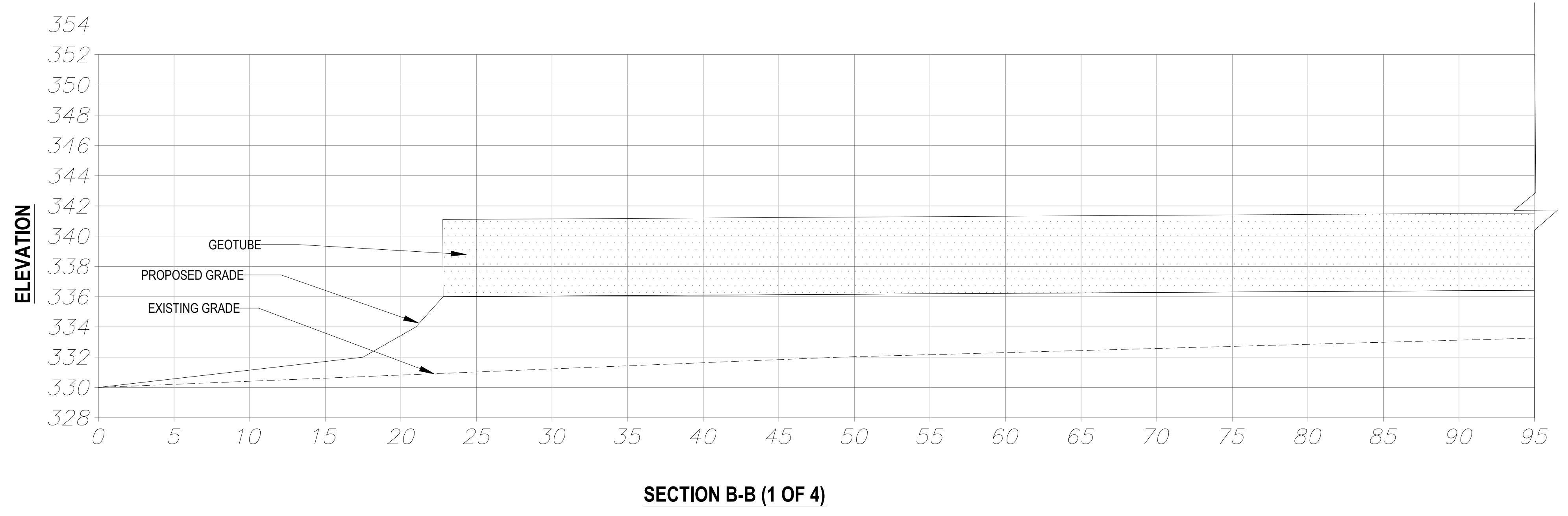
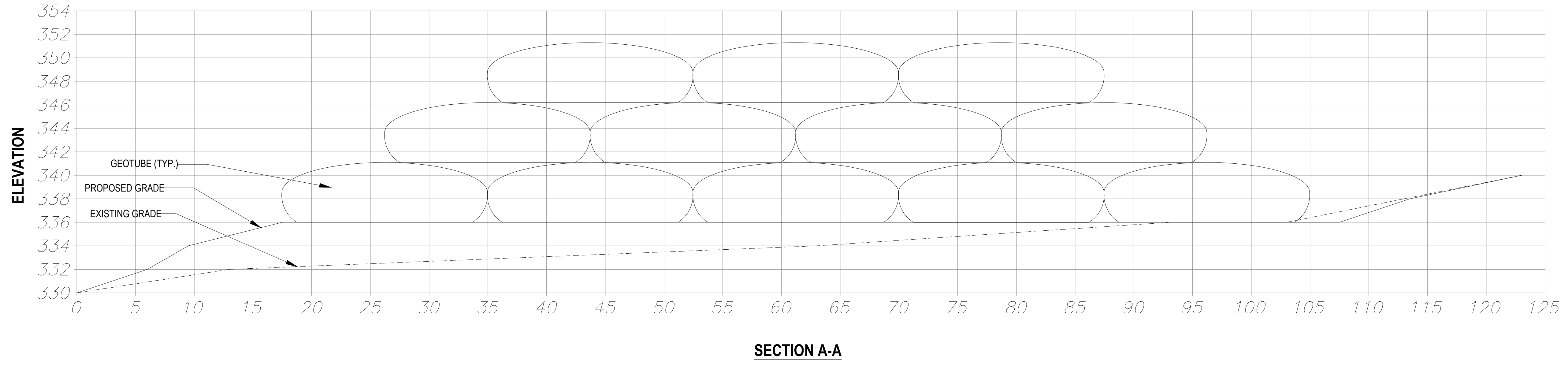

Drawing Path Name: C:\Users\US58677948\Desktop\Teatown Look\Current CAD Files\06062023\Teatown_Lake - Sections.dwg Printed: Jul 10, 2023, 3:29pm Layout: Layout1 (2)



WSP USA INC.
500 Summit Lake Drive, Suite 450
Valhalla, NY 10595
(914) 747-1120

ENGINEER OF RECORD:



NEW YORK STATE LICENSED
PROFESSIONAL ENGINEER

UNAUTHORIZED ALTERATIONS AND ADDITIONS TO THIS
DRAWING IS A VIOLATION OF SECTION 7209 (2)
OF THE NEW YORK STATE EDUCATION LAW

KEY PLAN:

REVISIONS:

PROJECT NAME:

**TEATOWN LAKE DREDGING
PROJECT**

WESTCHESTER COUNTY, NEW YORK

ISSUE DATE:

JUNE 2023

PROJECT NUMBER:

SCALE:

X

DRAWING NAME:

**SITE NO. 1 & 2 SECTIONS
(SHEET 2 OF 2)**

DRAWING NUMBER:

GR102

SHEET NUMBER:

8 OF 9

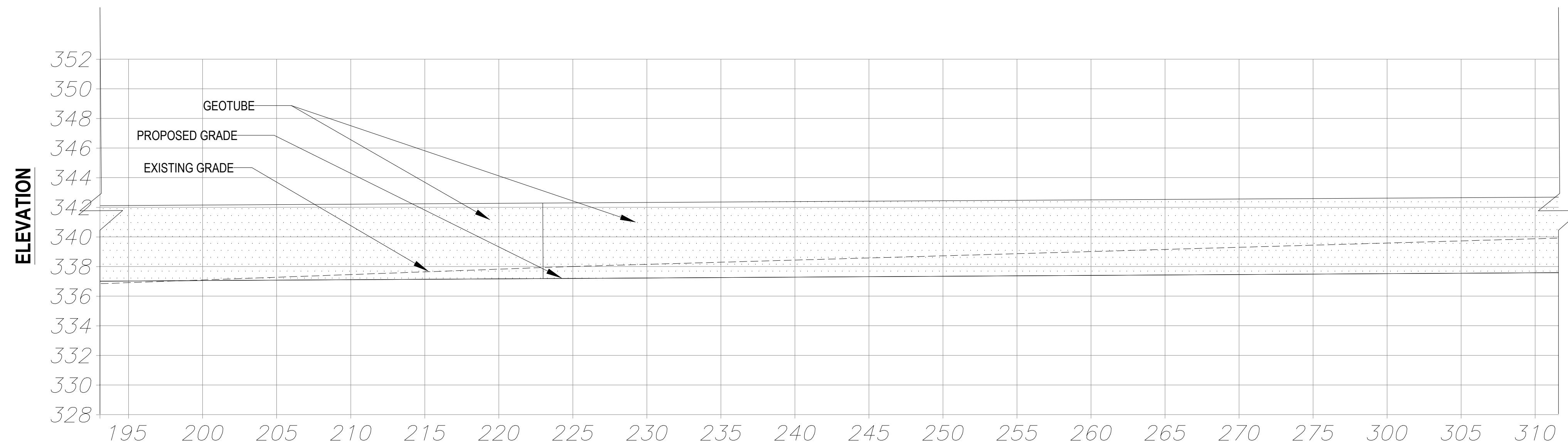

SECTION B-B (3 OF 4)

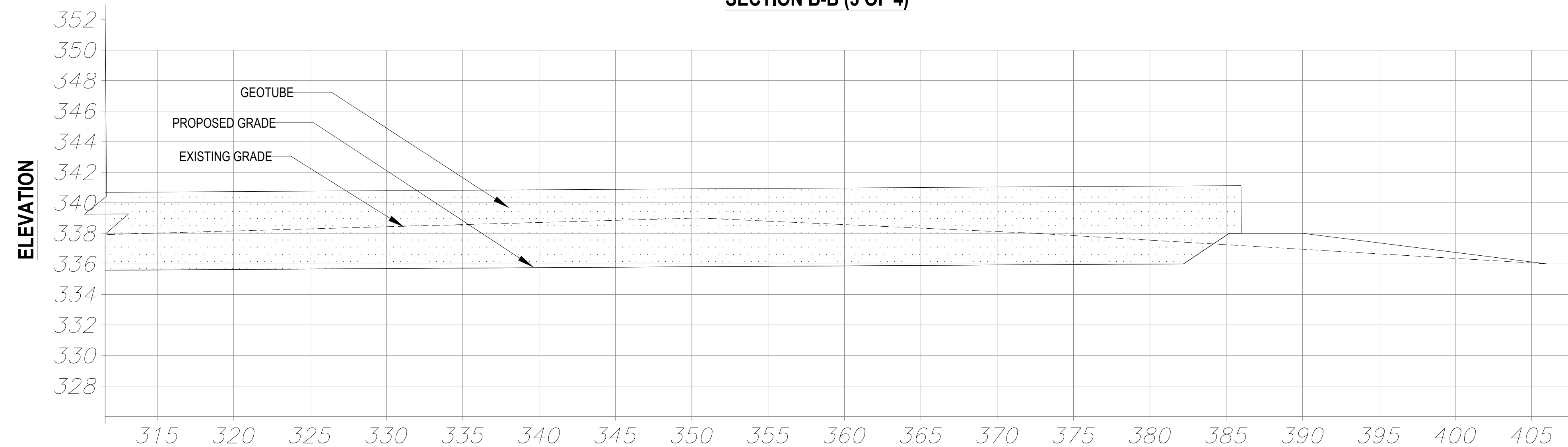

SECTION B-B (3 OF 4)

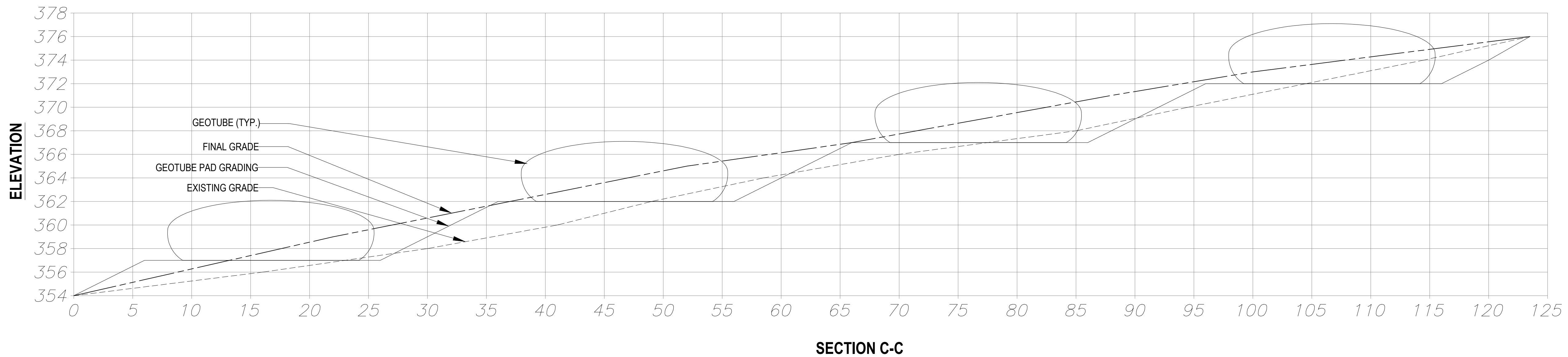

SECTION C-C

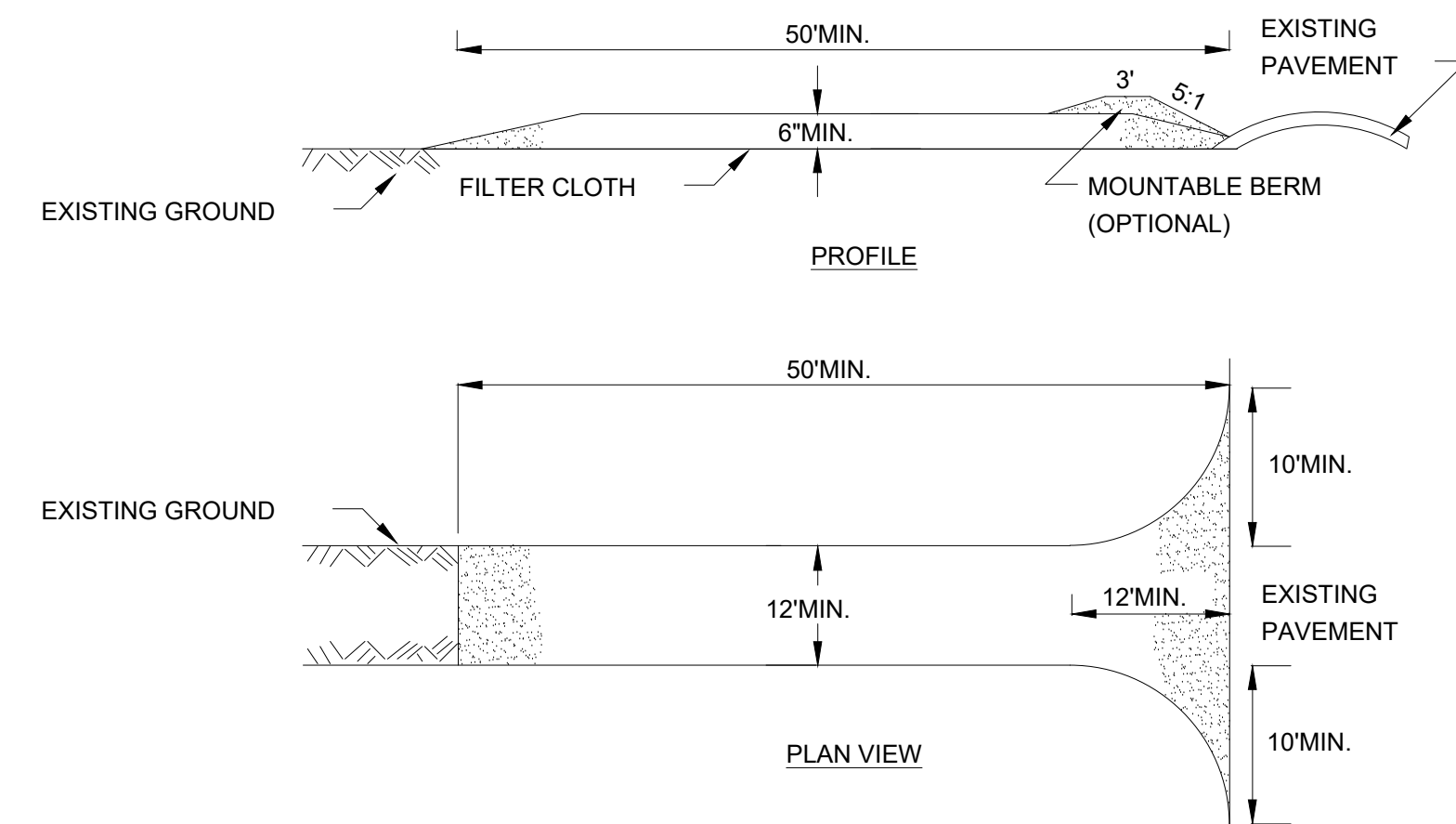

CONSTRUCTION ENTRANCE DETAIL
N.T.S.

CONSTRUCTION SPECIFICATIONS

1. STONE SIZE - USE 2" STONE, OR RECLAIMED OR RECYCLED CONCRETE EQUIVALENT.
2. LENGTH - NOT LESS THAN 50 FEET
3. THICKNESS - NOT LESS THAN SIX (6) INCHES.
4. WIDTH - TWELVE (12) FOOT MINIMUM, BUT NOT LESS THAN THE FULL WIDTH AT POINTS WHERE INGRESS OR EGRESS OCCURS. TWENTY-FOUR (24) FOOT IF SINGLE ENTRANCE TO SITE.
5. FILTER CLOTH - WILL BE PLACED OVER THE ENTIRE AREA PRIOR TO PLACING OF STONE.
6. SURFACE WATER - ALL SURFACE WATER FLOWING OR DIVERTED TOWARD CONSTRUCTION ENTRANCES SHALL BE PIPED ACROSS THE ENTRANCE. IF PIPING IS IMPRACTICAL, A MOUNTABLE BERM WITH 5:1 SLOPES WILL BE PERMITTED.
7. MAINTENANCE - THE ENTRANCE SHALL BE MAINTAINED IN A CONDITION WHICH WILL PREVENT TRACKING OR FLOWING OF SEDIMENT ONTO PUBLIC RIGHTS-OF-WAY. ALL SEDIMENT SPILLED, DROPPED, WASHED OR TRACTED ONTO PUBLIC RIGHTS-OF-WAY MUST BE REMOVED IMMEDIATELY.
8. WHEN WASHING IS REQUIRED, IT SHALL BE DONE ON A AREA STABILIZED WITH STONE AND WHICH DRAINS INTO AN APPROVED SEDIMENT TRAPPING DEVICE.
9. PERIODIC INSPECTION AND NEEDED MAINTENANCE SHALL BE PROVIDED AFTER EACH RAIN.

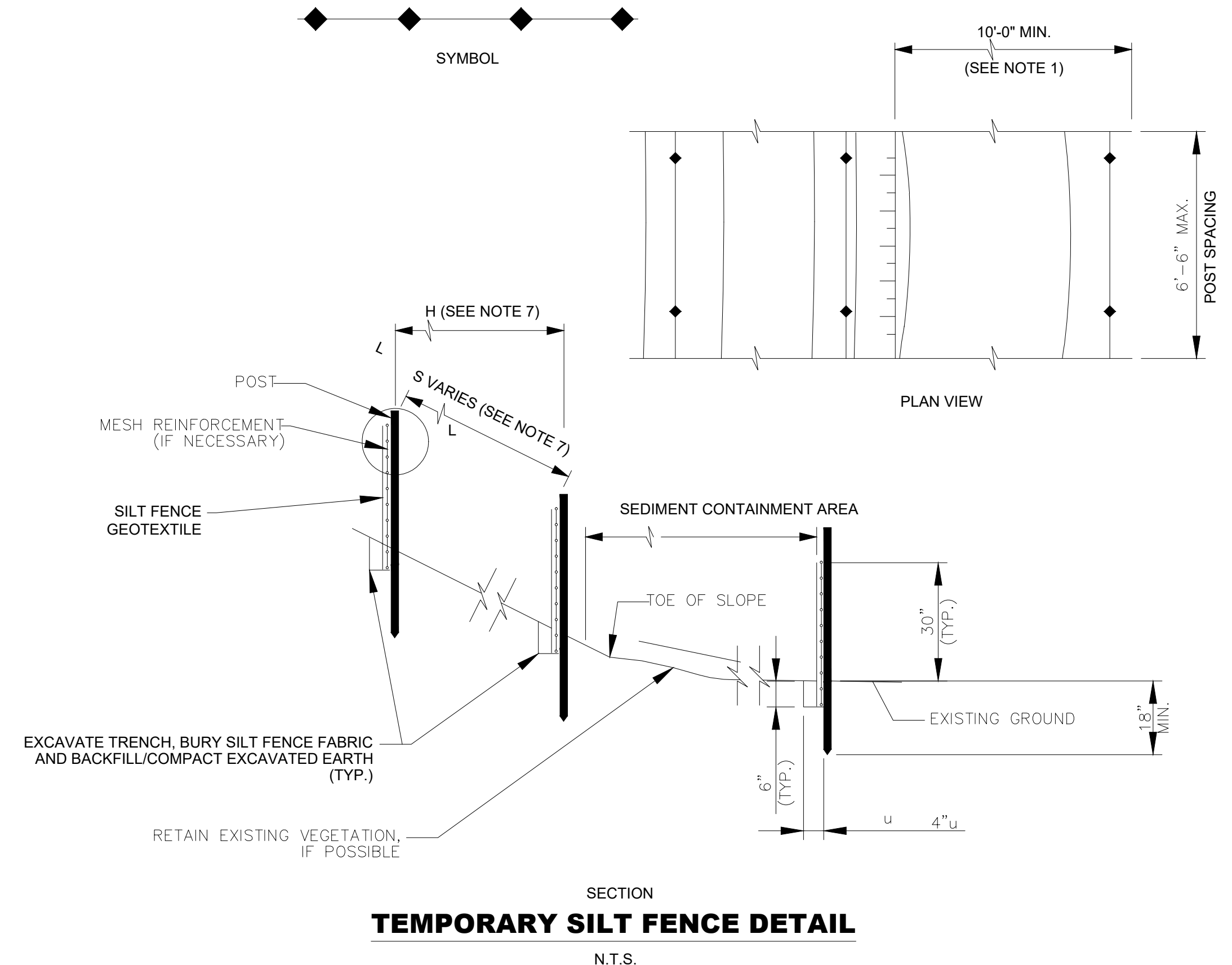

TEMPORARY SILT FENCE DETAIL
N.T.S.

GENERAL NOTES (SILT FENCE):

1. PLACEMENT OF SILT FENCE SHALL PROVIDE ADEQUATE AREA FOR SEDIMENT STORAGE AND FACILITATE MAINTENANCE OF SEDIMENT CONTAINMENT AREA.
2. POSTS MAY BE 1" X 1" (MIN.) HARDWOOD, 1" X 3" (MIN.) SOFTWOOD, OR 1.3 LB/FT (MIN.) STEEL. SPACING FOR THE PROVIDED SILT FENCE SHALL BE AS DESIGNATED ON THE DEPARTMENT APPROVED LIST FOR SILT FENCE.
3. THE BOTTOM EDGE OF SILT FENCE SHALL BE BURIED A MINIMUM OF 6" BELOW GROUND. THE FENCE SHALL BE INSTALLED WITH THE POSTS ON THE DOWNSTREAM SIDE OF THE FABRIC.
4. MEASURES SHALL BE INSPECTED EVERY SEVEN (7) CALENDAR DAYS OR AFTER EACH RAINFALL OF " OR MORE WITHIN A 24 HOUR PERIOD. MEASURES SHALL BE CLEANED AND REPAIRED AS REQUIRED.
5. SEDIMENT SHALL BE REMOVED WHEN ACCUMULATION REACHES ONE-HALF OF THE MEASURE HEIGHT. SEDIMENT SHALL BE DISPOSED OF AS UNSUITABLE MATERIAL.
6. DRAINAGE AREAS:
MAXIMUM DRAINAGE AREA TRIBUTARY TO 100'-0" OF SILT FENCE SHALL BE . ACRE.
THE FOLLOWING ARE MAXIMUM SLOPE LENGTHS TO THESE MEASURES:

| SLOPE | (L)SLOPE LENGTH (FT) | (H)HORIZ LENGTH(FT) |
|-------|----------------------|---------------------|
| 2:1 | 25 | 22 |
| 3:1 | 50 | 47 |
| 4:1 | 75 | 73 |
| 5:1 | 100 | 98 |
8. SILT FENCE INSTALLATION, INCLUDING EXCAVATION, BACKFILL, COMPACTION, MAINTENANCE & REMOVAL OF SILT FENCE SHALL BE INCLUDED IN THE UNIT PRICE BID FOR ITEM 209.13.

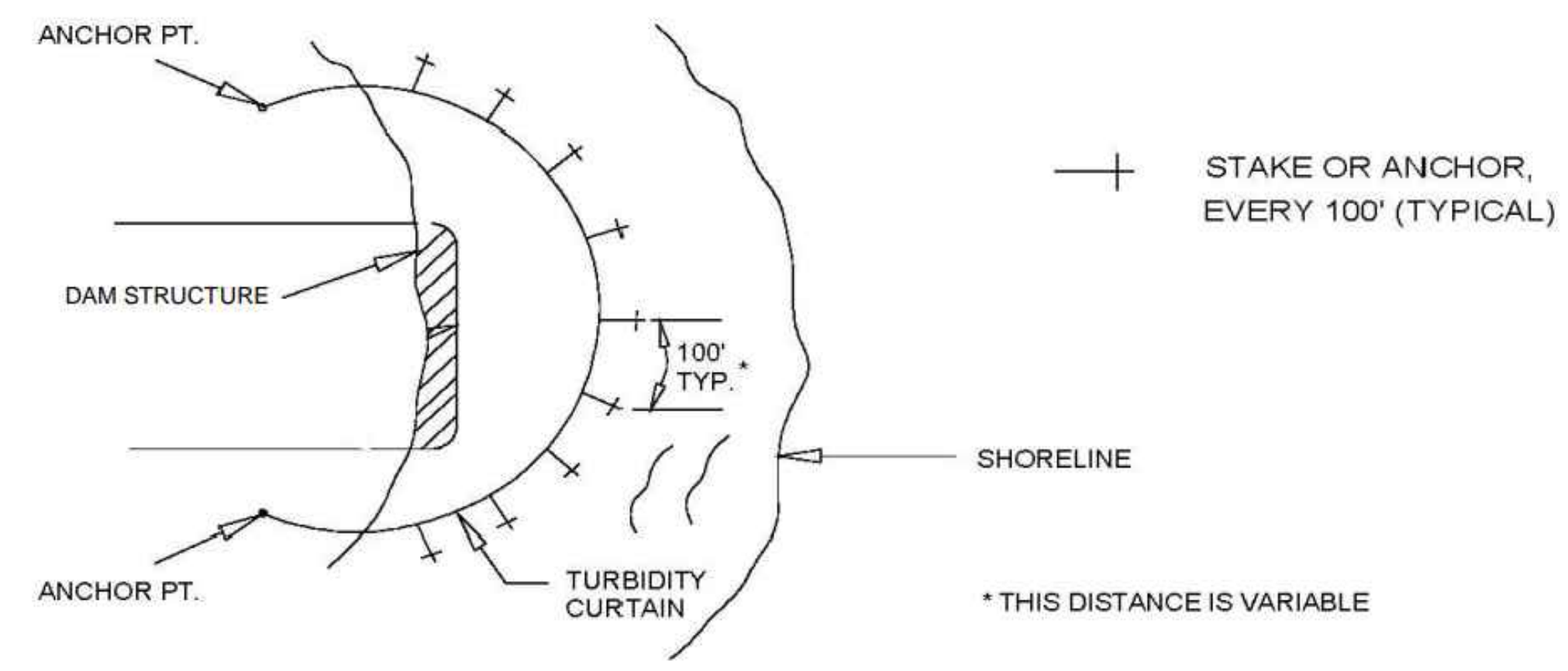

TURBIDITY CURTAIN DETAIL
N.T.S.

TURBIDITY CURTAIN NOTES:

1. A TURBIDITY CURTAIN OR SILT CURTAIN OF GEOTEXTILE FABRIC OR HEAVY PLASTIC SHALL BE INSTALLED IN THE WATER AROUND THE WORK ARE TO PREVENT SEDIMENT OR SEDIMENT-LADEN WATER FROM LEAVING THE IMMEDIATE WORK AREA.
2. TURBIDITY CURTAINS SHALL NOT BE INSTALLED ACROSS FLOWING WATER. THEY ARE INTENDED TO BE PLACED PARALLEL TO THE SHORELINE.
3. PRIOR TO A STORM EVENT OR ANTICIPATED HIGH WATER FLOWS, THE WORK AREA SHALL BE TEMPORARILY STABILIZED AND THE CURTAIN SHALL BE REMOVED TO PREVENT DAMAGE TO THE CURTAIN OR DOWNSTREAM AREAS.
4. CURTAINS SHALL BE MARKED WITH BRIGHT COLORS AND LIGHTS IF PLACED IN NAVIGABLE WATERS.
5. CURTAINS SHALL BE PROPERLY ANCHORED TO SHORE BY A FLOATATION LINE.
6. SEAMS SHALL BE SEALED AND INSPECTED REGULARLY FOR GAPS OR OPENINGS AND IF FOUND, REPAIRED IMMEDIATELY.
7. IF SEDIMENT OR SEDIMENT-LADEN WATERS ARE OBSERVED LEAVING THE IMMEDIATE WORK AREA, OPERATIONS SHALL CEASE AND THE TURBIDITY CURTAIN SHALL BE INSPECTED. IF THE CURTAIN IS FOUND TO NOT BE PROPERLY ANCHORED OR IS DAMAGED, REPAIRS/MODIFICATIONS SHALL BE MADE TO ENSURE IT IS FUNCTIONING PROPERLY BEFORE RESTARTING OPERATIONS. IF THE CURTAIN IS FOUND TO BE PROPERLY INSTALLED AND NO OTHER DAMAGE IS APPARENT, ADDITIONAL MEASURES SHALL BE PUT IN PLACE TO CONTAIN SEDIMENT OR SEDIMENT-LADEN WATERS WITHIN THE WORK AREA.
8. THE TURBIDITY CURTAIN SHALL REMAIN IN PLACE FOR AT LEAST 12 HOURS FOLLOWING COMPLETION OF WORK ACTIVITIES. THE TURBIDITY CURTAIN SHALL BE CAREFULLY REMOVED BY PULLING IT TOWARD THE SHORELINE TO MINIMIZE THE RELEASE OF ATTACHED SEDIMENT BACK INTO THE REGULATED WATER. SEDIMENTS SHALL BE PROPERLY DISPOSED OF IN AN UPLAND AREA.



WSP USA INC.
500 Summit Lake Drive, Suite 450
Valhalla, NY 10595
(914) 747-1120

ENGINEER OF RECORD:



NEW YORK STATE LICENSED PROFESSIONAL ENGINEER

UNAUTHORIZED ALTERATIONS AND ADDITIONS TO THIS DRAWING IS A VIOLATION OF SECTION 7209 (2) OF THE NEW YORK STATE EDUCATION LAW

KEY PLAN:

REVISIONS:

PROJECT NAME:

TEATOWN LAKE DREDGING PROJECT

WESTCHESTER COUNTY, NEW YORK

ISSUE DATE:

JUNE 2023

PROJECT NUMBER:

SCALE:

X

AS SHOWN

DRAWING NAME:

EROSION & SEDIMENT CONTROL DETAILS - 1

DRAWING NUMBER:

SHEET NUMBER:

DET101

9 OF 9